

**This electronic collection of documents is provided
for the convenience of the user
and is Not a Certified Document –**

**The documents contained herein were originally issued
and sealed by the individuals whose names and license
numbers appear on each page, on the dates appearing
with their signature on that page.**

**This file or an individual page
shall not be considered a certified document.**

CLEVELAND CO. RESURFACING MAP 1 thru 6

WBS Number	Sheet No.
2026CPT.12.08.20232	2



Rutherford Co.

Mt Pleasant
Lake Dam
Lake
Houser

Flint Hill

Jolly Mtn

South Carolina

No Scale

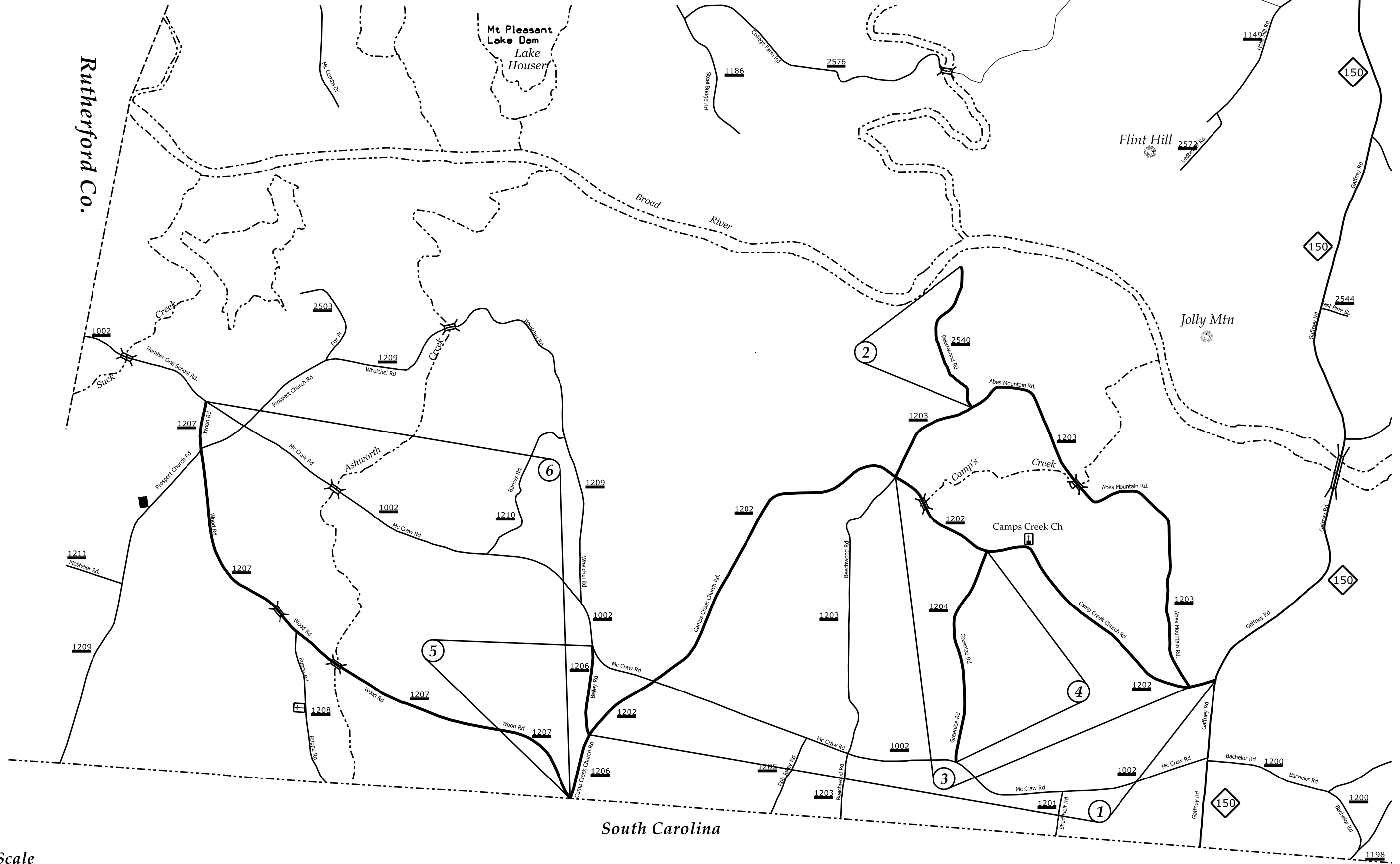

GASTON CO. RESURFACING MAP 7 & 8

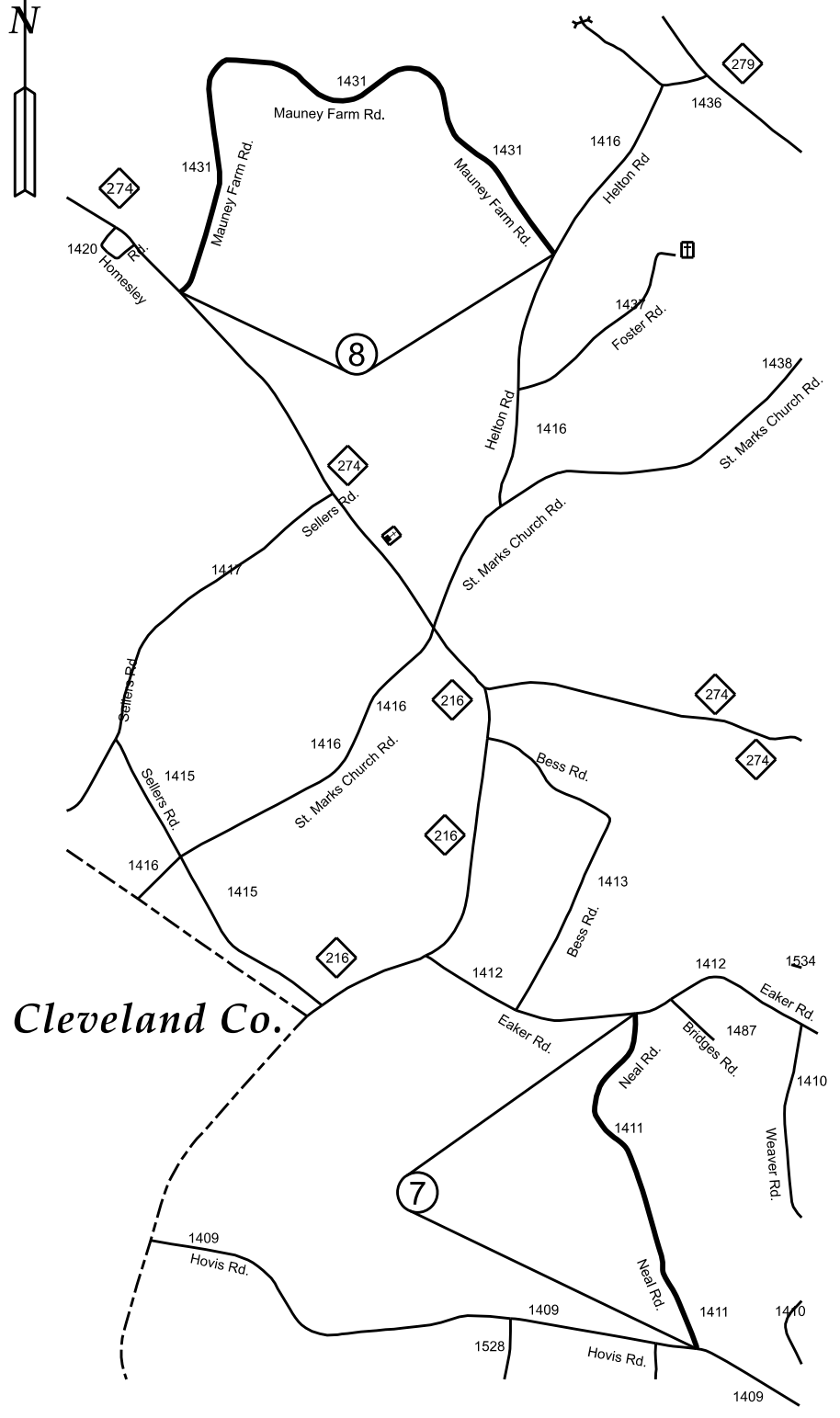

No Scale

GASTON CO. RESURFACING MAP 9

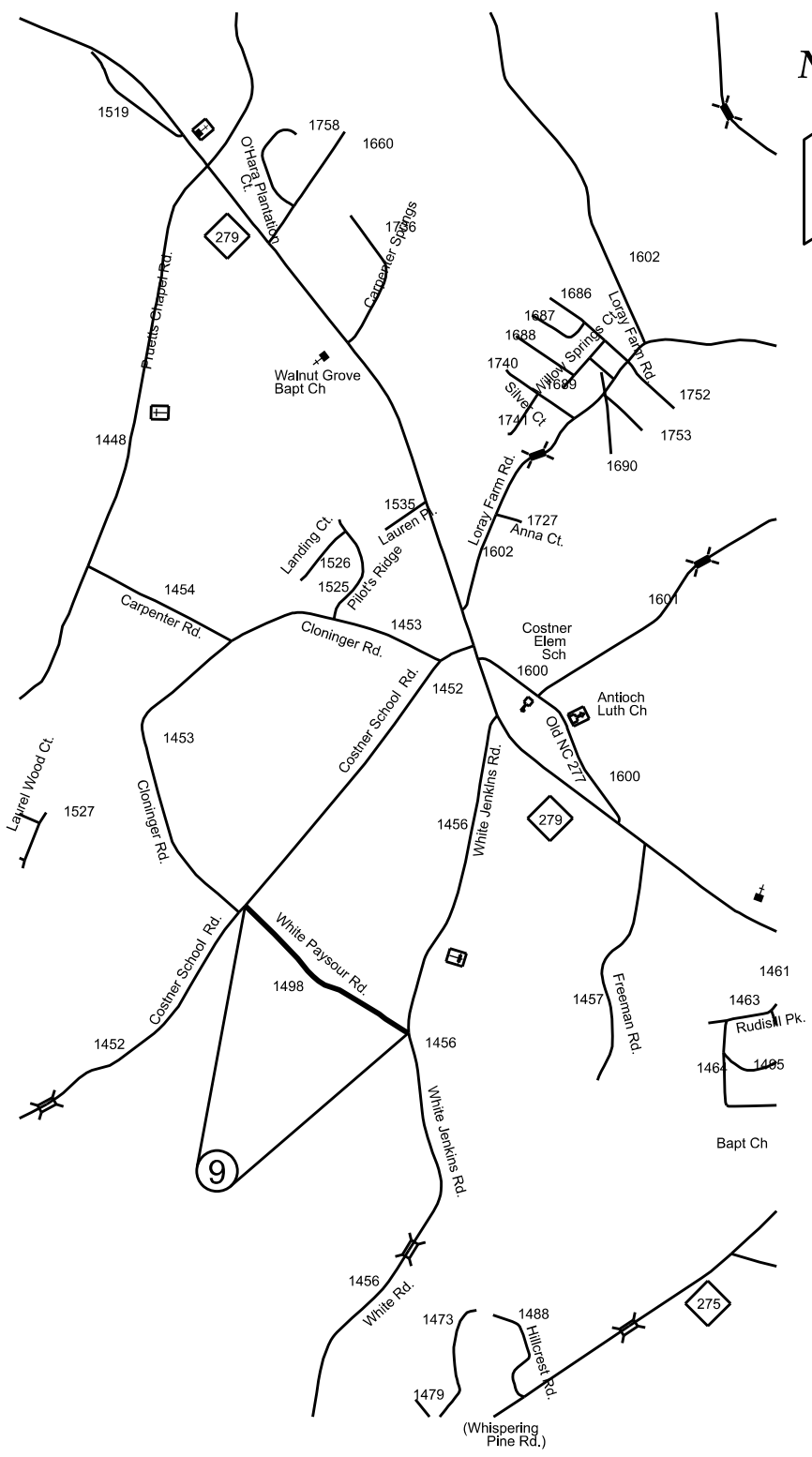

No Scale

GASTON CO. RESURFACING MAP 10

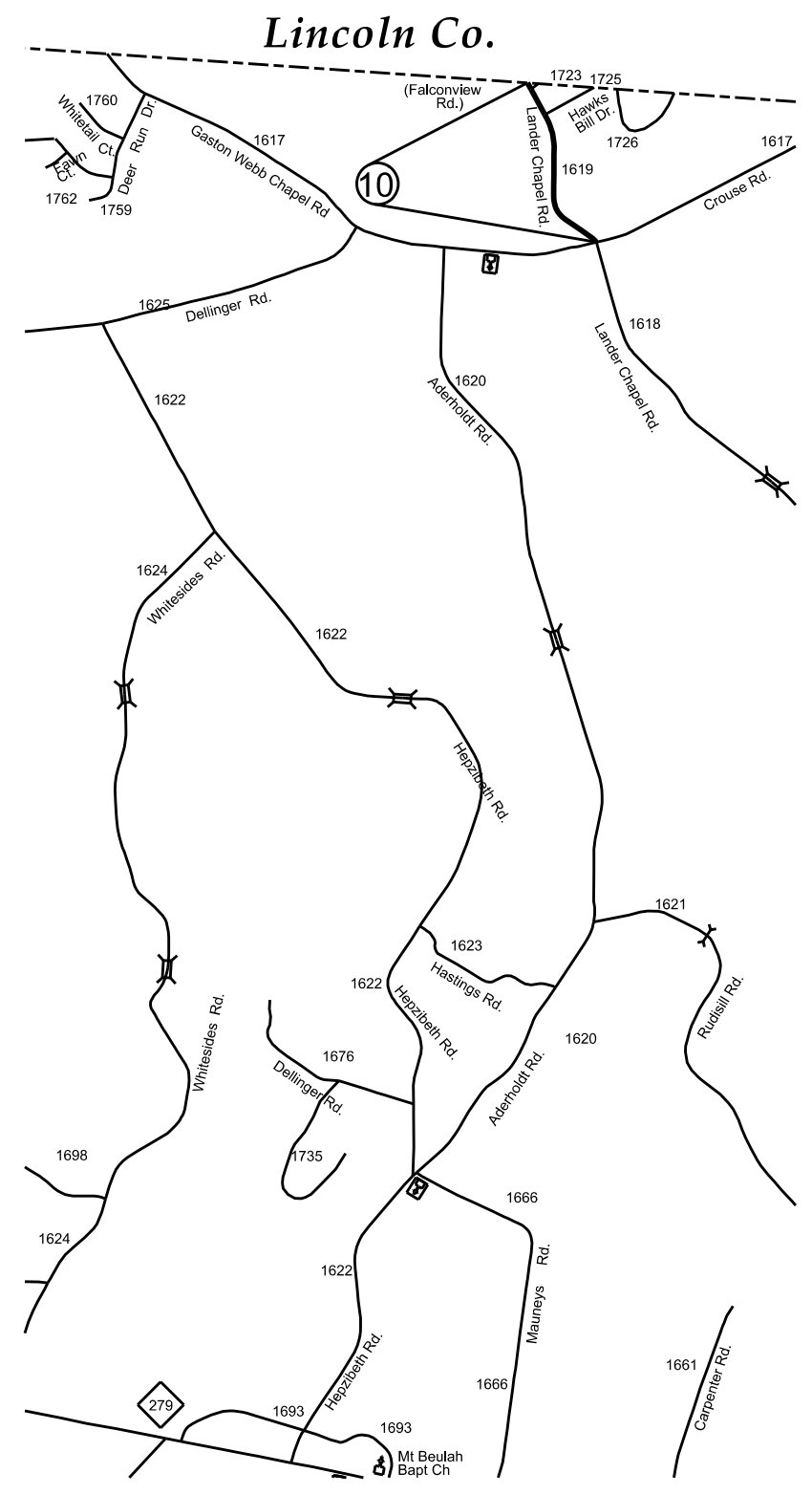

No Scale

GASTON CO. RESURFACING MAP 11

Lincoln Co.

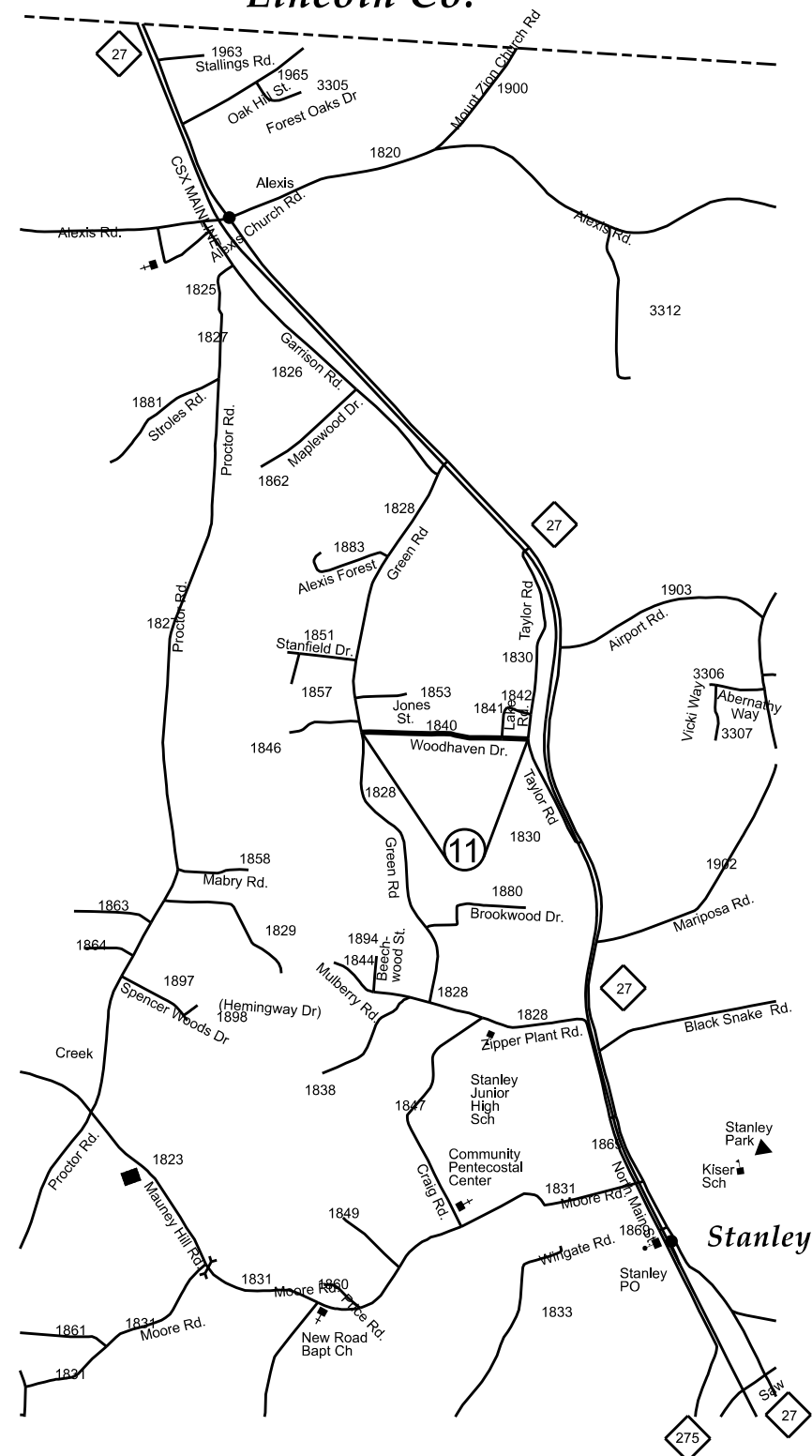

No Scale

GASTON CO. RESURFACING MAP 12

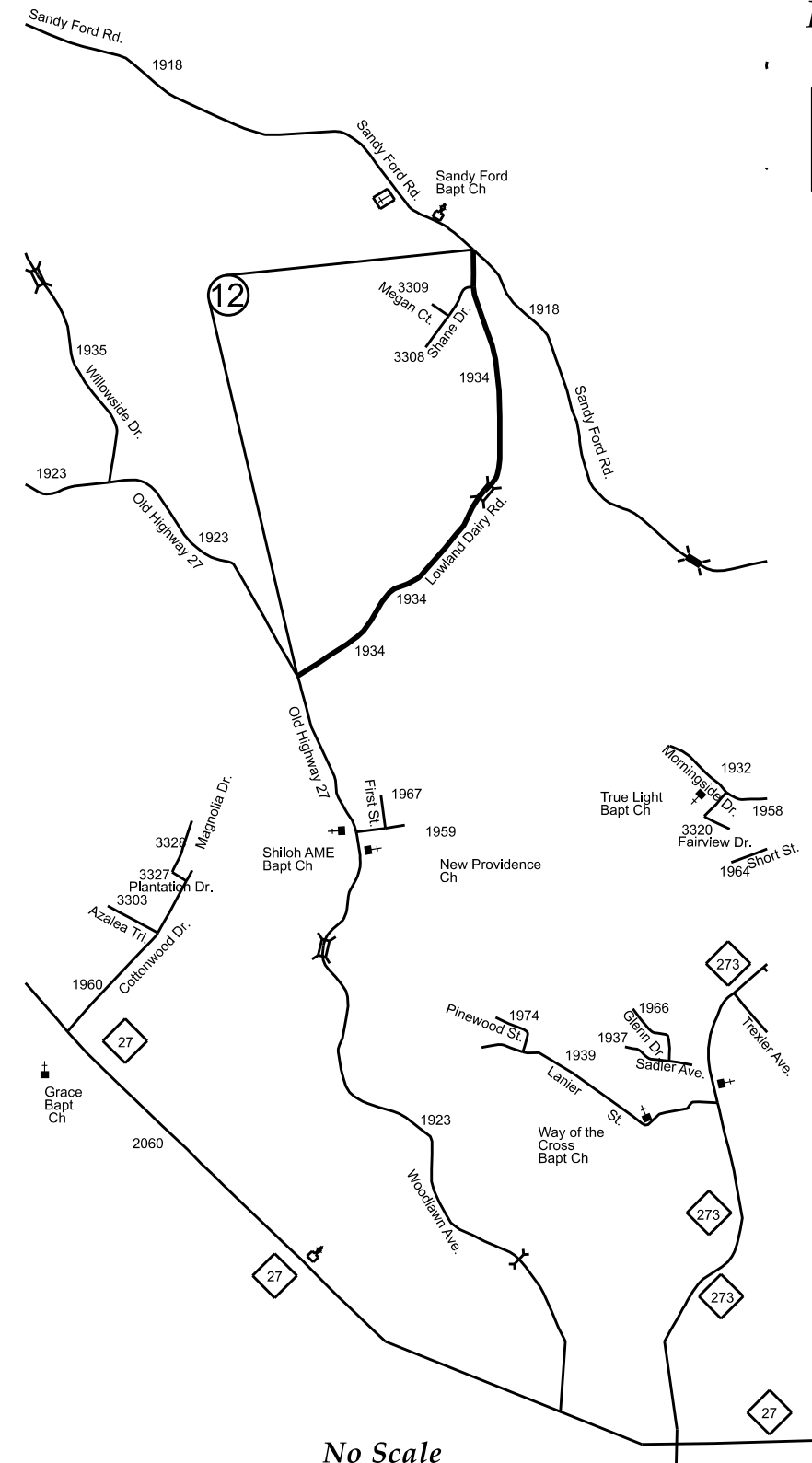

No Scale

GASTON CO. RESURFACING MAP 13

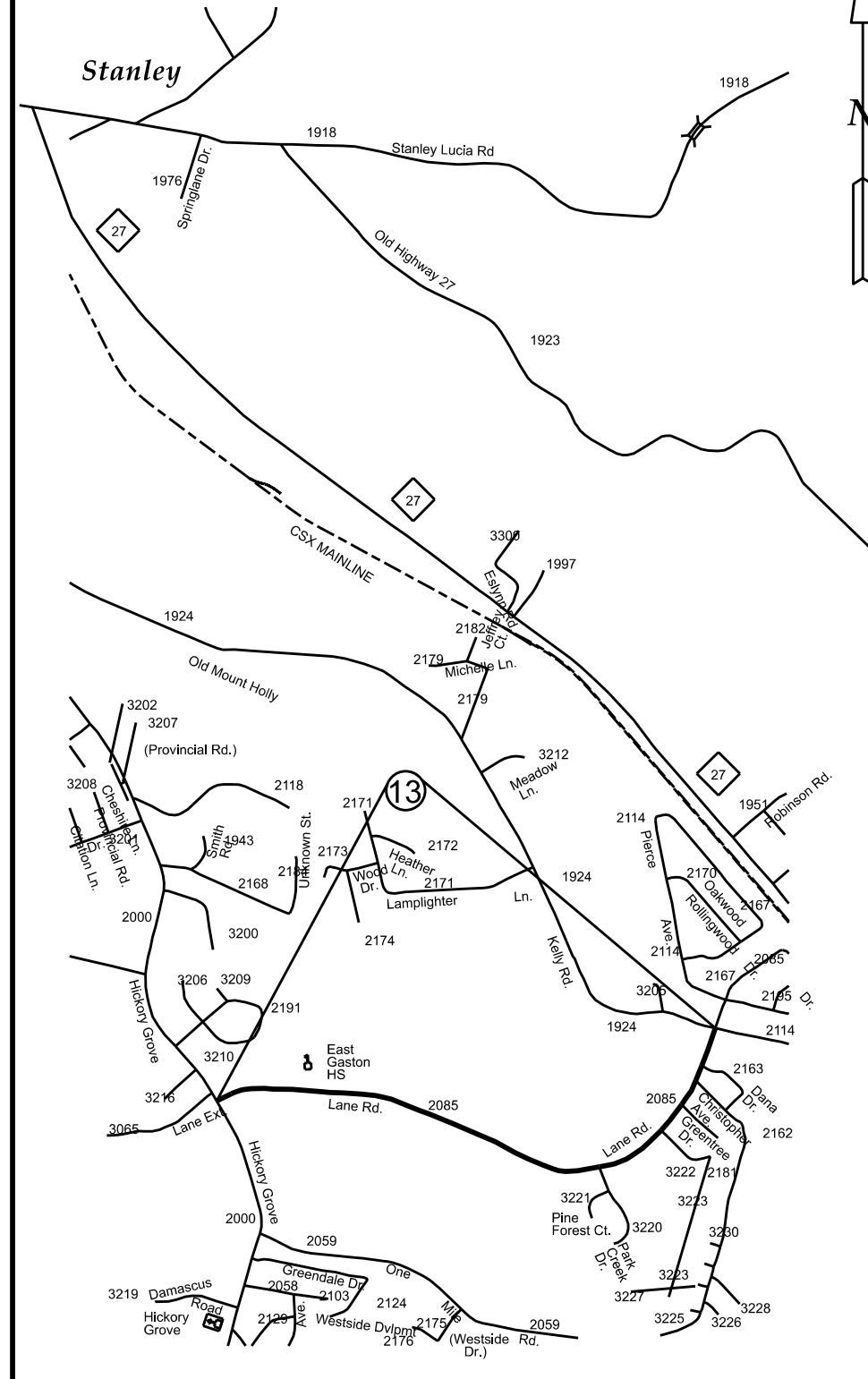

No Scale

GASTON CO. RESURFACING MAP 14 & 15

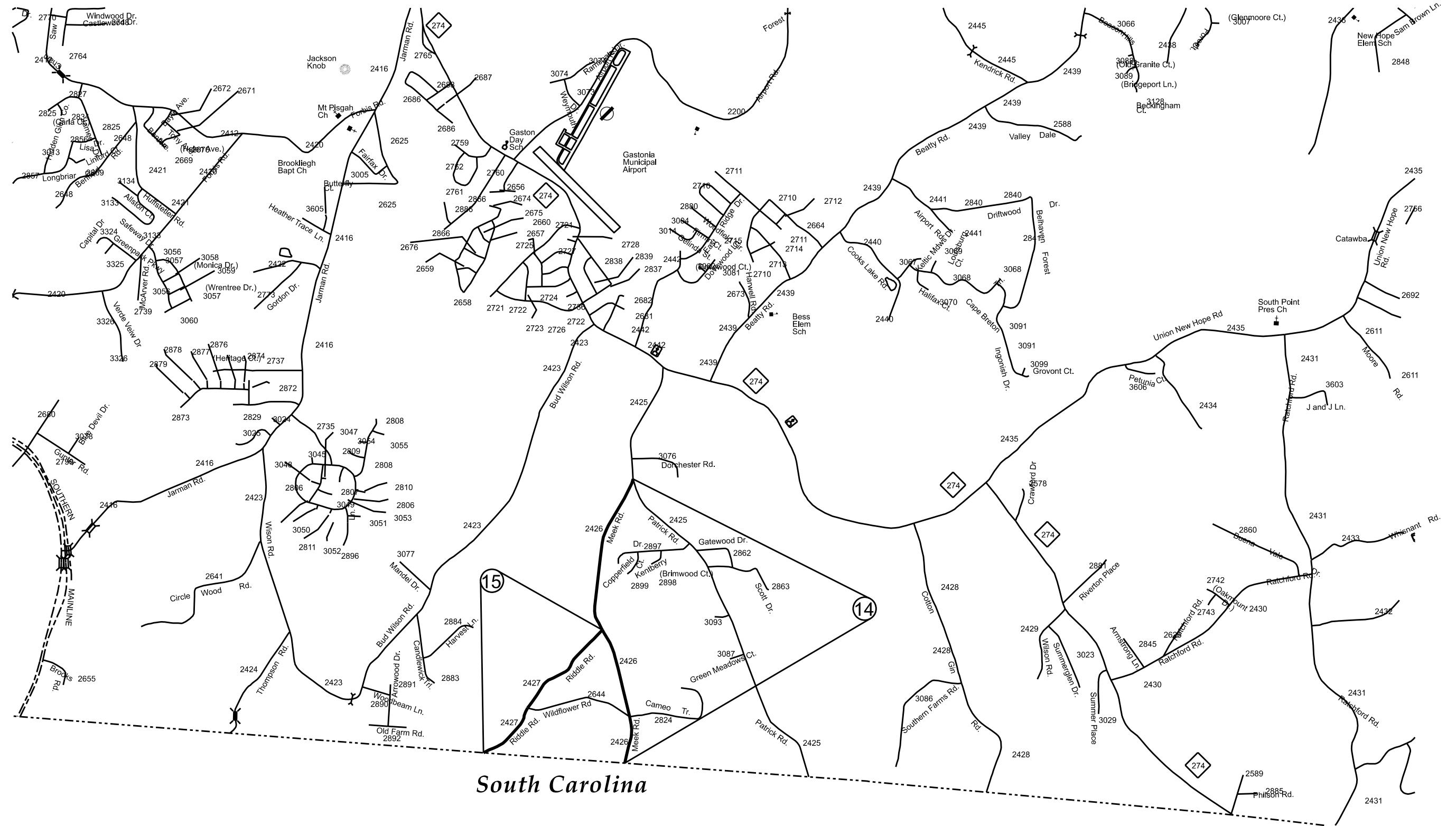

South Carolina

No Scale

PROJ. REFERENCE NO.	SHEET NO.	TOTAL SHEETS
2026CPT.12.08.20232	6	10
2026CPT.12.08.20362		

PAVEMENT SCHEDULE	
F	MICROSURFACING SINGLE COURSE TYPE III AT AN APPLICATION RATE OF 20 TO 24 POUNDS PER SQUARE YARD

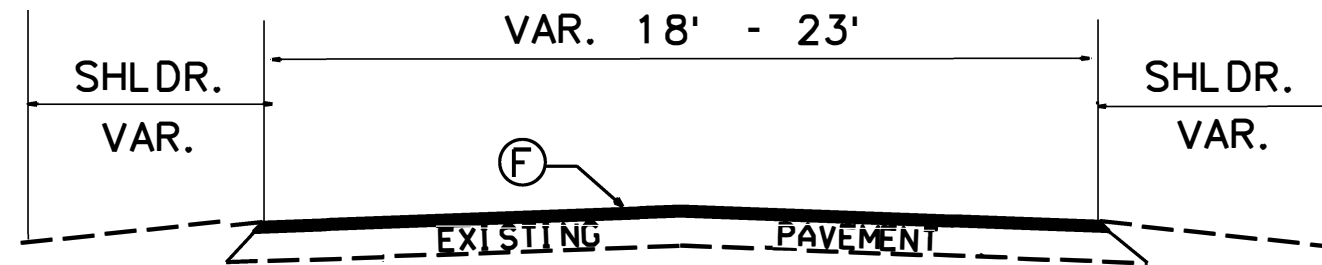

TYPICAL SECTION NO. 1
(MAPS 1-15)

2026 PAVEMENT PRESERVATION
CLEVELAND & GASTON COS.

PROJECT NO.	SHEET NO.	TOTAL NO.
2026CPT.12.08.20232		
2026CPT.12.08.20362		

SUMMARY OF QUANTITIES

PROJECT NO	COUNTY	MAP NO	ROUTE	DESCRIPTION	TYP NO	LANES	LANE TYPE	LENGTH	WIDTH	BEGIN	END	188000000-E	189100000-E	214300000-E
								MI	FT	MP	MP	MICRO SURFACING RUT FILL COURSE	MICRO SURFACING SINGLE COURSE ,TYPE III	BLOTTING SAND
												TON	SY	TON
2026CPT.12.08.20232	Cleveland	1	SR-1202 / CAMP CREEK CHURCH RD	FROM NC-150 / GAFFNEY RD TO SR-1206 / CAMP CREEK CH RD		2	2WU	3.72	19	0	3.72	500	45,612	7
TOTAL FOR MAP NO. 1								3.72				500	45,612	7
2026CPT.12.08.20232	Cleveland	2	SR-2540 / BEACHWOOD RD	FROM SR-1203 / ABES MOUNTAIN RD TO DEAD END		2	2WU	0.71	20	0	0.71		9,164	
TOTAL FOR MAP NO. 2								0.71					9,164	
2026CPT.12.08.20232	Alexander	3	SR-1203 / ABES MOUNTAIN RD	FROM SR-1202 / CAMP CREEK CH RD TO SR-1202 / CAMP CREEK CH RD		2	2WU	2.46	19	0	2.46		30,163	
TOTAL FOR MAP NO. 3								2.46					30,163	
2026CPT.12.08.20232	Cleveland	4	SR-1204 / GREENLEE RD	FROM SR-1002 / MCCRAW RD TO SR-1202 / CAMP CREEK CH RD		2	2WU	0.96	19	0	0.96		11,771	
TOTAL FOR MAP NO. 4								0.96					11,771	
2026CPT.12.08.20232	Cleveland	5	SR-1206 / BAILEY RD	FROM SR-1002 / MCCRAW RD TO SC STATELINE		2	2WU	0.68	18	0	0.68		7,899	
TOTAL FOR MAP NO. 5								0.68					7,899	
2026CPT.12.08.20232	Cleveland	6	SR-1207 / WOOD RD	FROM SR-1206 / CAMP CREEK CH RD TO SR-1002 / MCCRAW RD		2	2WU	2.64	19	0	2.64		32,370	
TOTAL FOR MAP NO. 6								2.64					32,370	
TOTAL FOR PROJ NO. 2026CPT.12.08.20232								11.17				500	136,979	7
2026CPT.12.08.20362	Gaston	7	SR-1411 / NEAL RD	FROM SR-1409 / SUNNYSIDE SHADY REST RD TO SR-1412 / EAKER RD		2	2WU	1.18	21	0	1.18		15,991	
TOTAL FOR MAP NO. 7								1.18					15,991	
2026CPT.12.08.20362	Gaston	8	SR-1431 / MAUNEY FARM RD	FROM NC-274 / TRYON COURTHOUSE RD TO SR-1416 / HELTON RD		2	2WU	2.2	21	0	2.2		29,814	7
TOTAL FOR MAP NO. 8								2.2					29,814	7
2026CPT.12.08.20362	Gaston	9	SR-1498 / WHITE PAYSOUR RD	FROM SR-1456 / WHITE JENKINS RD TO SR-1452 / COSTNER SCH RD		2	2WU	0.57	19	0	0.57	75	6,989	
TOTAL FOR MAP NO. 9								0.57				75	6,989	
2026CPT.12.08.20362	Gaston	10	SR-1619 / LANDERS CHAPEL RD	FROM SR-1617 / GASTON WEBB CHAPEL RD TO LINCOLN CO LINE		2	2WU	0.51	20	0	0.51	75	6,582	
TOTAL FOR MAP NO. 10								0.51				75	6,582	
2026CPT.12.08.20362	Gaston	11	SR-1840 / WOODHAVEN DR	FROM SR-1830 / TAYLOR RD TO SR-1828 / GREEN RD		2	2WU	0.47	20	0	0.47		6,066	
TOTAL FOR MAP NO. 11								0.47					6,066	
2026CPT.12.08.20362	Gaston	12	SR-1934 / LOWLAND DAIRY RD	FROM SR-1918 / SANDY FORD RD TO SR-1923 / OLD HIGHWAY 27		2	2WU	1.47	20	0	1.47		21,490	
TOTAL FOR MAP NO. 12								1.47					21,490	
2026CPT.12.08.20362	Gaston	13	SR-2085 / LANE RD	FROM SR-1924 / KELLY RD TO SR-2000 / HICKORY GROVE RD		2	2WU	1.73	23	0.32	2.05		25,898	
TOTAL FOR MAP NO. 13								1.73					25,898	
2026CPT.12.08.20362	Gaston	14	SR-2426 / MEEKS RD	FROM SR-2425 / PATRICK RD TO S.C. STATELINE		2	2WU	1.48	23	0	1.48		21,967	
TOTAL FOR MAP NO. 14								1.48					21,967	
2026CPT.12.08.20362	Gaston	15	SR-2427 / RIDDLE RD	FROM SR-2426 / MEEKS RD TO S.C. STATELINE		2	2WU	0.86	20	0	0.86		11,100	
TOTAL FOR MAP NO. 15								0.86					11,100	
TOTAL FOR PROJ NO. 2026CPT.12.08.20362								10.47				150	145,897	7
GRAND TOTAL								21.64				650	282,876	14

PROJECT NO.	SHEET NO.	TOTAL NO.
2026CPT.12.08.20232, 2026CPT.12.08.20362		

THERMOPLASTIC AND PAINT QUANTITIES

PROJECT NO	COUNTY	MAP NO	ROUTE	DESCRIPTION	TYP NO	LANES	LANE TYPE	LENGTH	WIDTH	BEGIN MP	END MP	4413000000-E	4457000000-N	4700000000-E	4709000000-E	4720000000-E	4725000000-E			4810000000-E		4865000000-E	4870000000-E	4875000000-E						
												WORK ZONE ADV/GEN WARNING SIGNS	TEMPORARY TRAFFIC CONTROL	12" X 90 M YELLOW THERMO	24" X 90 M WHITE THERMO	THERMO MSG SCHOOL 90 M	THERMO LT ARROW 90 M	THERMO RT ARROW 90 M	4" WHITE PAINT	4" YELLOW PAINT	REMOVAL OF PAVEMENT MARKING LINES, 12"	REMOVAL OF PAVEMENT MARKING LINES, 24"	REMOVAL OF PAVEMENT MARKING SYMBOLS & CHARACTERS							
												SF	LS	LF	LF	EA	EA	EA	LF	LF	LF	LF	EA							
2026CPT.12.08.20232	Cleveland	1	SR-1202 / CAMP CREEK CHURCH RD	FROM NC-150 / GAFFNEY RD TO SR-1206 / CAMP CREEK CH RD		2	2WU	3.72	19	0	3.72	228								80,054	80,054									
TOTAL FOR MAP NO. 1								3.72				228								80,054	80,054									
2026CPT.12.08.20232	Cleveland	2	SR-2540 / BEACHWOOD RD	FROM SR-1203 / ABES MOUNTAIN RD TO DEAD END		2	2WU	0.71	20	0	0.71	84								15,279	15,279									
TOTAL FOR MAP NO. 2								0.71				84								15,279	15,279									
2026CPT.12.08.20232	Alexander	3	SR-1203 / ABES MOUNTAIN RD	FROM SR-1202 / CAMP CREEK CH RD TO SR-1202 / CAMP CREEK CH RD		2	2WU	2.46	19	0	2.46	149								52,939	52,939									
TOTAL FOR MAP NO. 3								2.46				149									52,939	52,939								
2026CPT.12.08.20232	Cleveland	4	SR-1204 / GREENLEE RD	FROM SR-1002 / MCCRAW RD TO SR-1202 / CAMP CREEK CH RD		2	2WU	0.96	19	0	0.96	84								20,659	20,659									
TOTAL FOR MAP NO. 4								0.96				84									20,659	20,659								
2026CPT.12.08.20232	Cleveland	5	SR-1206 / BAILEY RD	FROM SR-1002 / MCCRAW RD TO SC STATELINE		2	2WU	0.68	18	0	0.68	84								14,634	14,634									
TOTAL FOR MAP NO. 5								0.68				84									14,634	14,634								
2026CPT.12.08.20232	Cleveland	6	SR-1207 / WOOD RD	FROM SR-1206 / CAMP CREEK CH RD TO SR-1002 / MCCRAW RD		2	2WU	2.64	19	0	2.64	245								56,813	56,813									
TOTAL FOR MAP NO. 6								2.64				245									56,813	56,813								
TOTAL FOR PROJ NO. 2026CPT.12.08.20232								11.17				874									240,378	240,378								
																			480,756											
2026CPT.12.08.20362	Gaston	7	SR-1411 / NEAL RD	FROM SR-1409 / SUNNYSIDE SHADY REST RD TO SR-1412 / EAKER RD		2	2WU	1.18	21	0	1.18	84								25,394	15,576									
TOTAL FOR MAP NO. 7								1.18				84									25,394	15,576								
2026CPT.12.08.20362	Gaston	8	SR-1431 / MAUNEY FARM RD	FROM NC-274 / TRYON COURTHOUSE RD TO SR-1416 / HELTON RD		2	2WU	2.2	21	0	2.2	148								47,344	39,040									
TOTAL FOR MAP NO. 8								2.2				148									47,344	39,040								
2026CPT.12.08.20362	Gaston	9	SR-1498 / WHITE PAYSOUR RD	FROM SR-1456 / WHITE JENKINS RD TO SR-1452 / COSTNER SCH RD		2	2WU	0.57	19	0	0.57	84								12,266	12,266									
TOTAL FOR MAP NO. 9								0.57				84									12,266	12,266								
2026CPT.12.08.20362	Gaston	10	SR-1619 / LANDERS CHAPEL RD	FROM SR-1617 / GASTON WEBB CHAPEL RD TO LINCOLN CO LINE		2	2WU	0.51	20	0	0.51	84								10,975	10,975									
TOTAL FOR MAP NO. 10								0.51				84									10,975	10,975								
2026CPT.12.08.20362	Gaston	11	SR-1840 / WOODHAVEN DR	FROM SR-1830 / TAYLOR RD TO SR-1828 / GREEN RD		2	2WU	0.47	20	0	0.47	84								10,114	10,114									
TOTAL FOR MAP NO. 11								0.47				84									10,114	10,114								
2026CPT.12.08.20362	Gaston	12	SR-1934 / LOWLAND DAIRY RD	FROM SR-1918 / SANDY FORD RD TO SR-1923 / OLD HIGHWAY 27		2	2WU	1.47	20	0	1.47	116								200	380	200	380	3						
TOTAL FOR MAP NO. 12								1.47				116									200	380	200	380	3					
2026CPT.12.08.20362	Gaston	13	SR-2085 / LANE RD	FROM SR-1924 / KELLY RD TO SR-2000 / HICKORY GROVE RD		2	2WU	1.73	23	0.32	2.05	148								37,430	37,230	140	16							
TOTAL FOR MAP NO. 13								1.73				148									140	12	2	2	37,430	37,230	140	16		
2026CPT.12.08.20362	Gaston	14	SR-2426 / MEEKS RD	FROM SR-2425 / PATRICK RD TO S.C. STATELINE		2	2WU	1.48	23	0	1.48	116								31,850	31,850	23								
TOTAL FOR MAP NO. 14								1.48				116									23	31,850	31,850	23						
2026CPT.12.08.20362	Gaston	15	SR-2427 / RIDDLE RD	FROM SR-2426 / MEEKS RD TO S.C. STATELINE		2	2WU	0.86	20	0	0.86	84								18,507	18,507									
TOTAL FOR MAP NO. 15								0.86				84									18,507	18,507								
TOTAL FOR PROJ NO. 2026CPT.12.08.20362								10.47				948									200	543	12	4	3	225,814	211,768	200	543	19
																			7											
GRAND TOTAL								21.64				1,822	1	200	543	12	4	3	466,192	452,146	200	543	19							
																			7		918,338									

SIGNING FOR ASPHALT SURFACE TREATMENT

LEGEND

- ▷ PORTABLE SIGN
- └ STATIONARY SIGN
- ← DIRECTION OF TRAFFIC FLOW

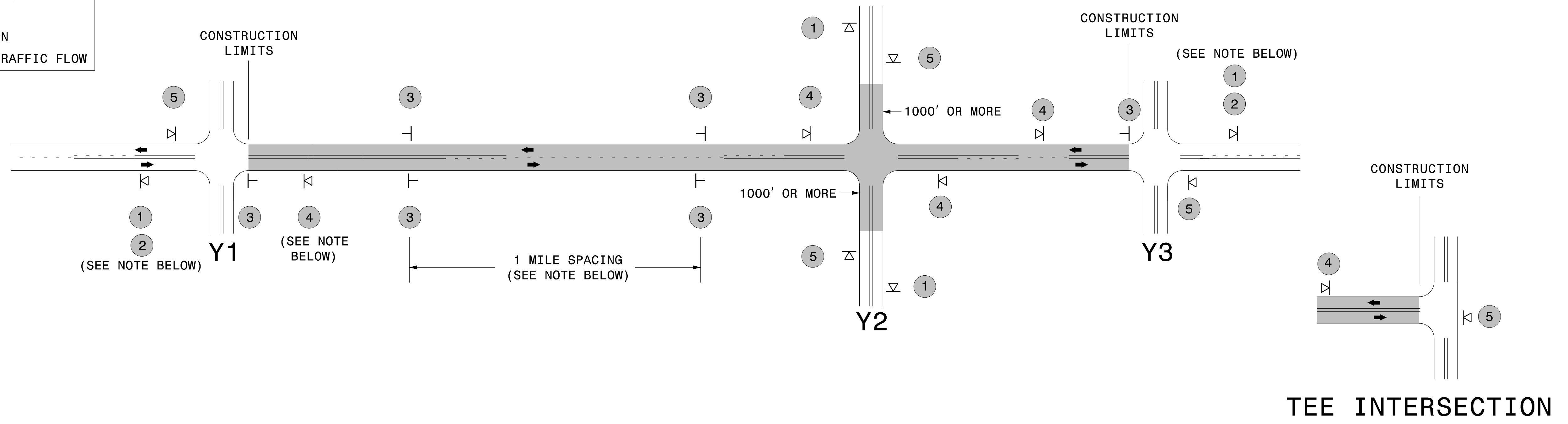

MAINLINE (-L-) SIGNING

-Y- LINE SIGNING

SIGNING NOTES AND PLACEMENT PER DIRECTION	1	 	<ul style="list-style-type: none"> - PLACE 1000' PRIOR TO BEGINNING OF CONSTRUCTION LIMITS. ONLY USED ON -Y- LINES IF RESURFACING LIMITS EXTEND 1000' ALONG -Y- LINE. - SIGN #2 ONLY USED WHEN RESURFACING LIMITS ARE 2 OR MORE MILES IN LENGTH. ROUND UP TO THE NEAREST WHOLE NUMBER. DO NOT USE FRACTIONAL OR DECIMAL NUMBERS. 	<p>STATIONARY SIGNING NOT REQUIRED FOR THE FOLLOWING -Y- LINE CONDITIONS:</p> <ol style="list-style-type: none"> 1) LESS THAN 1000' OF RESURFACING ALONG -Y- LINE 2) SUBDIVISION ROADS 3) DEAD END ROADS <p>WHEN PAVING/CONSTRUCTION ACTIVITIES PROCEED ACROSS AN UNSIGNED -Y- LINE, PORTABLE ADVANCE WARNING SIGNS SHALL BE USED ALONG THE -Y- LINE AS SHOWN BELOW. REMOVE UPON COMPLETION OF WORK.</p> <div style="display: flex; justify-content: space-around;"> <div style="text-align: center;"> W20-1 48" X 48" PLACED 500' IN ADVANCE OF FLAGGER. </div> <div style="text-align: center;"> W20-7 A 48" X 48" PLACED 250' IN ADVANCE OF FLAGGER. </div> </div>
	3	 	<ul style="list-style-type: none"> - ALTERNATE THE FOLLOWING TWO SIGNS: - STARTING WITH "LOOSE GRAVEL" (W8-7) FOLLOWED BY "UNMARKED PAVEMENT". - PLACE INITIALLY AT THE CONSTRUCTION LIMITS AND SPACED 1 MILE APART THEREAFTER. - AT TEE INTERSECTIONS INSTALL INITIALLY 0.5 MILE FROM INTERSECTION AND SPACE 1 MILE APART THEREAFTER. 	
	4		<ul style="list-style-type: none"> - THESE ARE FOR -Y- LINES THAT ARE "THROUGH" ROADWAYS. DEAD END AND SUBDIVISION ROADS ARE NOT "THROUGH" ROADWAYS. - INSTALL 500' +/- FROM EACH -Y- LINE APPROACH AS SHOWN ABOVE. - FOR MULTIPLE -Y- LINES THAT ARE SEPARATED BY 0.25 MILES OR LESS, TREAT AS A SINGLE UNIT AND INSTALL WITHIN 500' OF EACH APPROACH. - A MAXIMUM OF 2 SIGN SETS PER MILE. DO NOT INSTALL WHEN -Y- LINES ARE WITHIN 0.5 MILES FROM "END ROAD WORK" SIGN. 	
	5		<ul style="list-style-type: none"> - PLACE 500' FOLLOWING THE END OF CONSTRUCTION LIMITS OR AS SHOWN WHEN WORK ENDS AT A 3-WAY TEE INTERSECTION. 	
	<p>THE ABOVE SIGNS ARE ALL THAT ARE REQUIRED FOR A CONTRACTOR TO BEGIN A RESURFACING CONTRACT. ANY ADDITIONAL SIGNS REQUESTED BY NCDOT DIVISIONS SHALL BE INSTALLED WITHIN 7 BUSINESS DAYS OF THE START OF CONTRACT WORK.</p>			

MAPS LESS THAN 2 MILES

FOR AST RESURFACING MAPS WITH CONSTRUCTION LIMITS LESS THAN 2 MILES IN LENGTH, USE A STATIONARY "LOOSE GRAVEL" SIGN AT THE BEGINNING CONSTRUCTION LIMIT FOLLOWED BY AN "UNMARKED PAVEMENT" SIGN MIDWAY THROUGH AND AN "END ROAD WORK" SIGN AT THE END CONSTRUCTION LIMIT.

ADVANCE WARNING SIGNS FOR 2-LANE ROADWAY ASPHALT SURFACE TREATMENT